

ACCOMMODATIONS SYMBOL LEGEND

- ★ 2 Twin Beds (convert to King) and Single Sofa Bed
- ◆ 2 Twin Beds (convert to King) and 1 Upper Pullman
- ⚙ 2 Twin Beds (do not convert to King) and 1 Upper Pullman
- 2 Twin Beds (convert to King), Single Sofa Bed and 1 Upper Pullman
- King Bed (does not convert to Twin beds), Single Sofa Bed and 1 Upper Pullman
- ⋮ 2 Twin Beds (convert to King) and 2 Upper Pullmans
- † 2 Twin Beds (convert to King) and Double Sofa Bed
- ∞ 2 Twin Beds (convert to King), Double Sofa Bed and 1 Upper Pullman
- ◇ 2 Twin Beds (convert to King), 1 Lower Pullman, and 1 Upper Pullman
- ◆ Stateroom with 2 Porthole Windows
- △ Connecting staterooms (ideal for families and groups of friends)
- ★ Twin beds do not convert to a King Bed.
- King Bed does not convert to Twin Beds
- U Unisex Wheelchair Accessible Restroom
- 8A 8B 8C 8D Balcony Staterooms: Beds do not convert to King when both Upper Pullmans in use

All accommodations are non-smoking.

Accessible staterooms are available for guests with disabilities. Please contact Guest Access Services at 1-800-438-6744 ext. 70025 for details, or visit <https://www.carnival.com/about-carnival/special-needs.aspx>.

CATEGORIES

- 1A Interior Upper/Lower
- PT Porthole
- 4A 4B 4C 4D 4E 4I Interior
- 6A 6B 6C 6D 6E Ocean View
- 6J Scenic Ocean View
- 8A 8B 8C 8D Balcony
- 8M Aft-View Extended Balcony
- 0B Junior Suite (obstructed views)
- JS JT Junior Suite
- GS Grand Suite
- ES Extended Balcony Grand Suite
- GV Grand Vista Suite

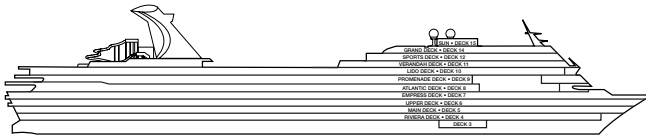

Gross Tonnage: 71,925 Length: 855 Feet Beam: 103 Feet
Cruising Speed: 21 Knots Guest Capacity: 2124 (Double Occupancy)
Total Staff: 920 Registry: Panama

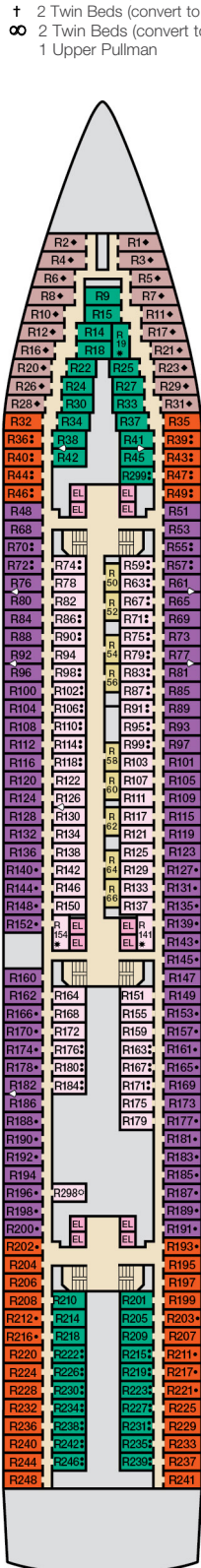

Riviera • Deck 4

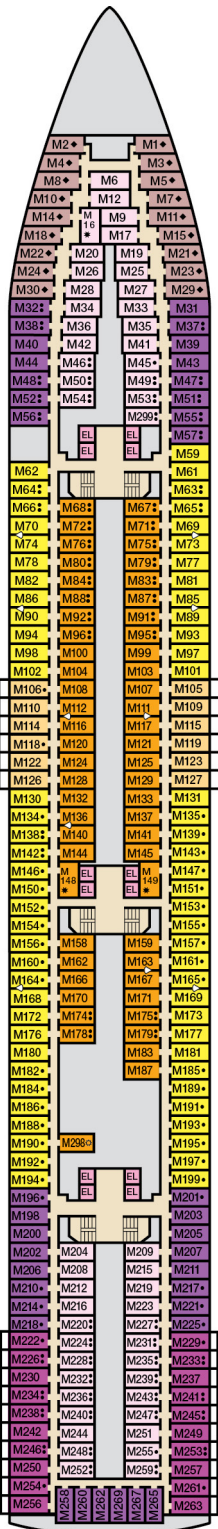

Main • Deck 5

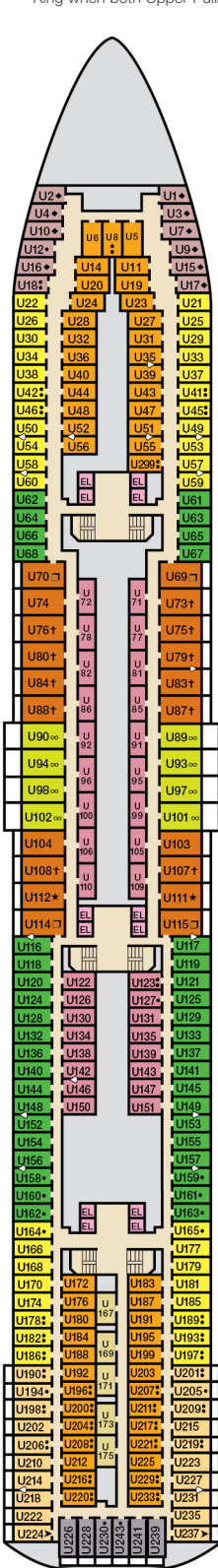

Upper • Deck 6

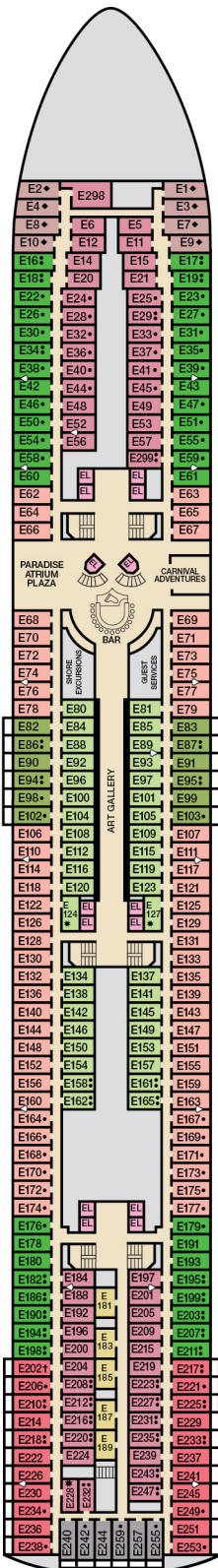

Empress • Deck 7

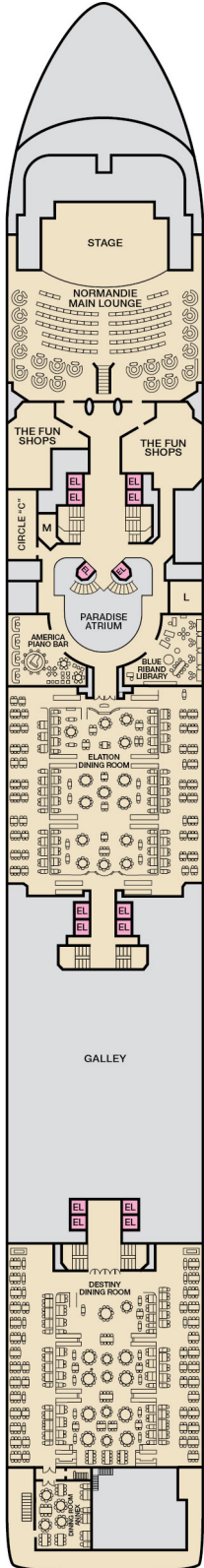

Atlantic • Deck 8

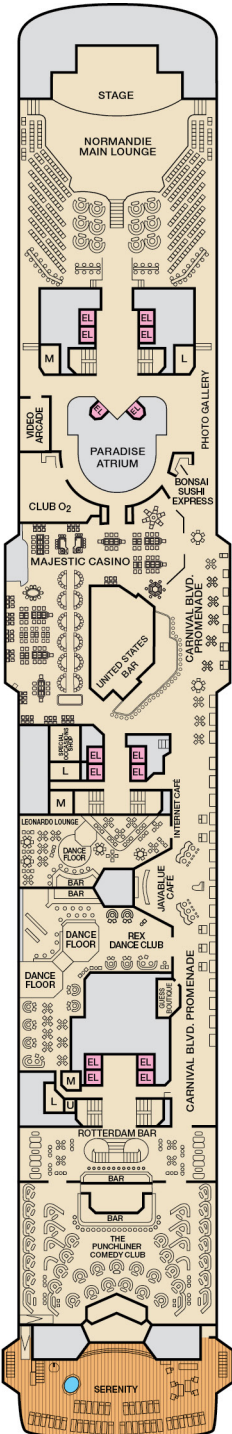

Promenade • Deck 9

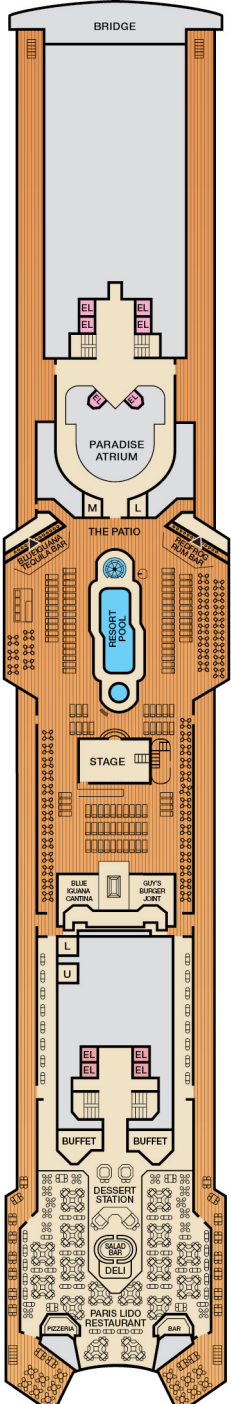

Lido • Deck 10

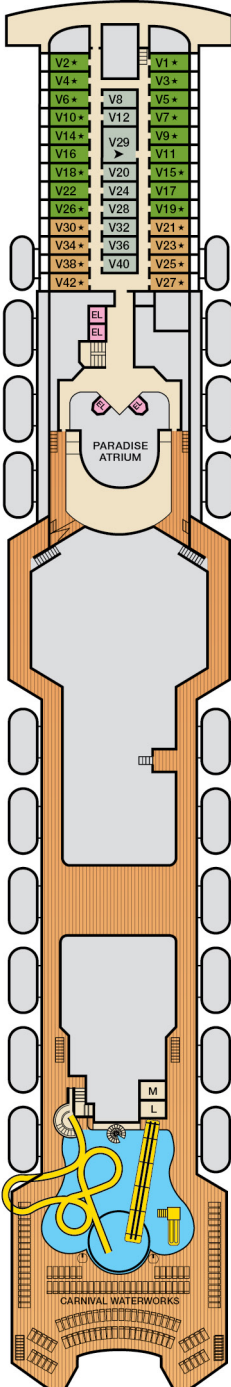

Verandah • Deck 11

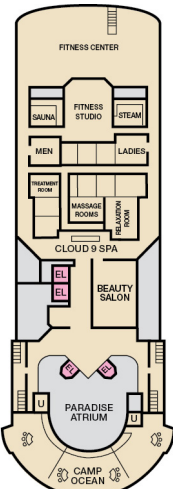

Forward Sports • Deck 12

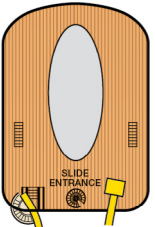

Aft Sports • Deck 12

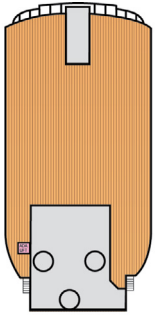

Sun • Deck 15

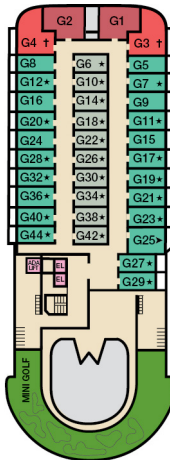

Grand • Deck 14

ACCOMMODATIONS SYMBOL LEGEND

- ★ 2 Twin Beds (convert to King) and Single Sofa Bed
- 2 Twin Beds (convert to King) and 1 Upper Pullman
- ⊙ 2 Twin Beds (do not convert to King) and 1 Upper Pullman
- 2 Twin Beds (convert to King), Single Sofa Bed and 1 Upper Pullman
- King Bed (does not convert to Twin beds), Single Sofa Bed and 1 Upper Pullman
- ⋈ 2 Twin Beds (convert to King) and 2 Upper Pullmans

- † 2 Twin Beds (convert to King) and Double Sofa Bed
- ∞ 2 Twin Beds (convert to King), Double Sofa Bed and 1 Upper Pullman
- ◇ 2 Twin Beds (convert to King), 1 Lower Pullman, and 1 Upper Pullman
- ◆ Stateroom with 2 Porthole Windows
- △ Connecting staterooms (ideal for families and groups of friends)
- ★ Twin beds do not convert to a King Bed.
- King Bed does not convert to Twin Beds
- U Unisex Wheelchair Accessible Restroom

- 🚭 All accommodations are non-smoking.
- Accessible Routes including Ramps
- Restrooms, Elevators, Lifts and other Accessible Areas
- Fully Accessible Staterooms (FAC)
- Fully Accessible Staterooms - Single Side Approach (FAC-SSA)
- Ambulatory Accessible Staterooms (AAC)

DECK PLANS

Please contact Guest Access Services for specific ship accessibility features. You may also visit <https://www.carnival.com/about-carnival/special-needs.aspx>

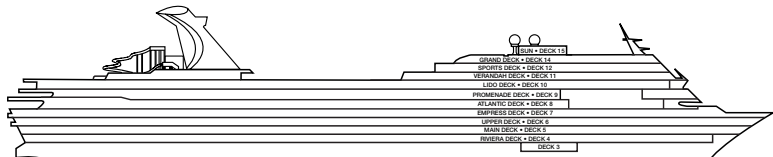

Gross Tonnage: 71,925 Length: 855 Feet Beam: 103 Feet Cruising Speed: 21 Knots
Guest Capacity: 2124 (Double Occupancy) Total Staff: 920 Registry: Panama

