

ACCOMMODATIONS SYMBOL LEGEND

- ▲ Twin Bed and Single Sofa Bed
- ★ Twin Beds do not convert to a King Bed
- ★ 2 Twin Beds (convert to King) and Single Sofa Bed
- ★ King Bed (does not convert to Twin Beds) and Single Sofa Bed
- 2 Twin Beds (convert to King) and 1 Upper Pullman
- 2 Twin Beds (convert to King), Single Sofa Bed and 1 Upper Pullman

- † 2 Twin Beds (convert to King) and Double Sofa Bed
- 2 Twin Beds (convert to King) and 2 Upper Pullmans
- 2 Twin Beds (convert to King), Single Sofa Bed with Convertible Bunk
- ♦ 2 Twin Beds (convert to King), Single Sofa Bed, 1 Upper Pullman and 1 Lower Pullman
- ♦ Stateroom with 2 Porthole Windows
- ◁ Connecting Staterooms (ideal for families and groups of friends)

68 Staterooms with obstructed views: 2446, 2449.

All accommodations are non-smoking.

Accessible staterooms are available for guests with disabilities. Please contact Guest Access Services at 1-800-438-6744 ext. 70025 for details, or visit <http://www.carnival.com/about-carnival/special-needs>.

CATEGORIES

- 1A Interior Upper/Lower
- PT Porthole
- 4A 4B 4C 4D 4E 4F 4G 4H Interior
- 4J Interior with Picture Window (obstructed views)
- 6A 6B 6C Ocean View
- 8A 8B 8C 8D 8E 8F Balcony
- 8M 8N Aft-View Extended Balcony
- 9B Premium Balcony
- 9C Premium Vista Balcony
- 9S Junior Suite
- OS Ocean Suite
- GS Grand Suite
- CS Captain's Suite

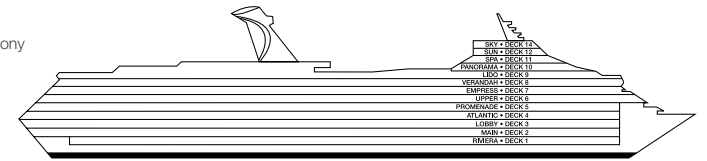

Gross Tonnage: 110,000 Length: 952 Feet Beam: 116 Feet
 Cruising Speed: 21 Knots Guest Capacity: 2,974 (Double Occupancy)
 Total Staff: 1,150 Registry: Panama

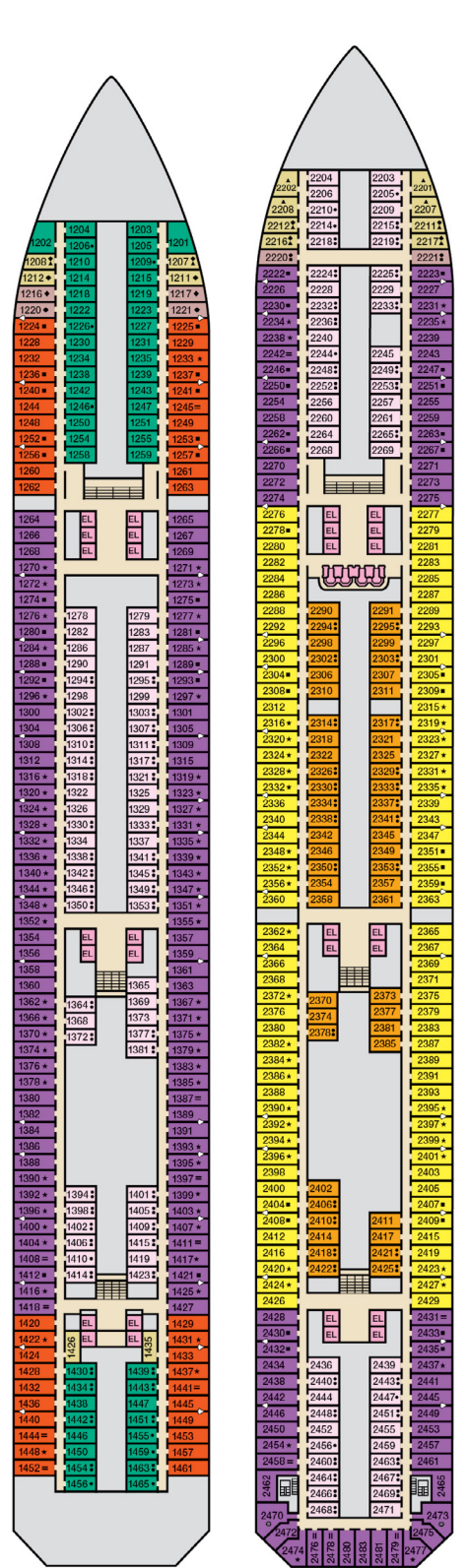

Riviera • Deck 1

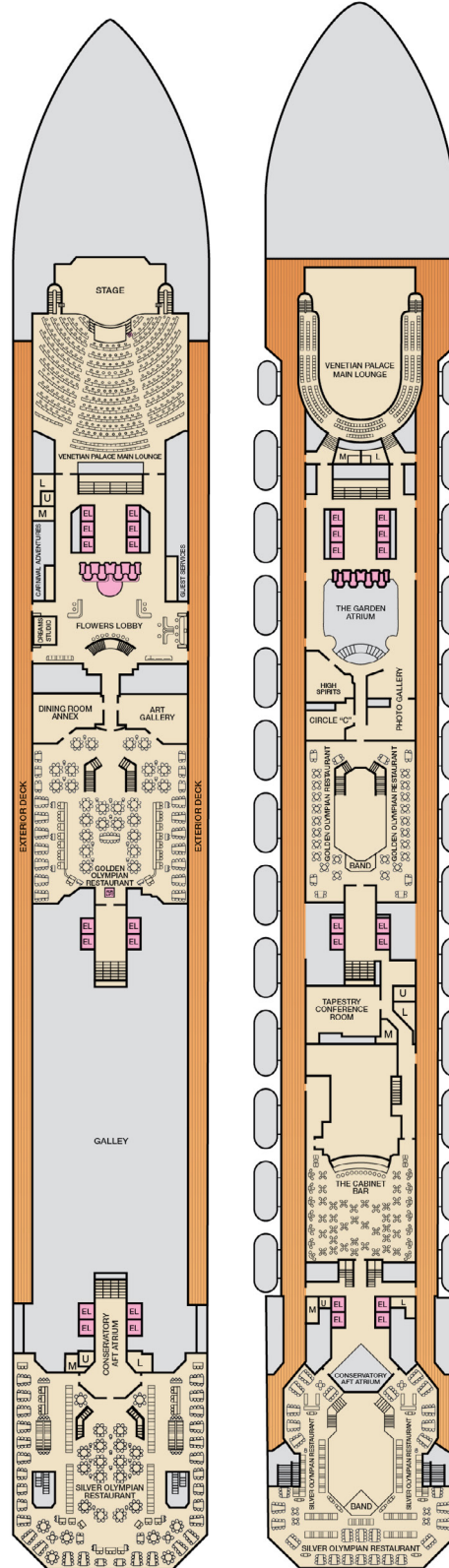

Main • Deck 2



Lobby • Deck 3



Atlantic • Deck 4

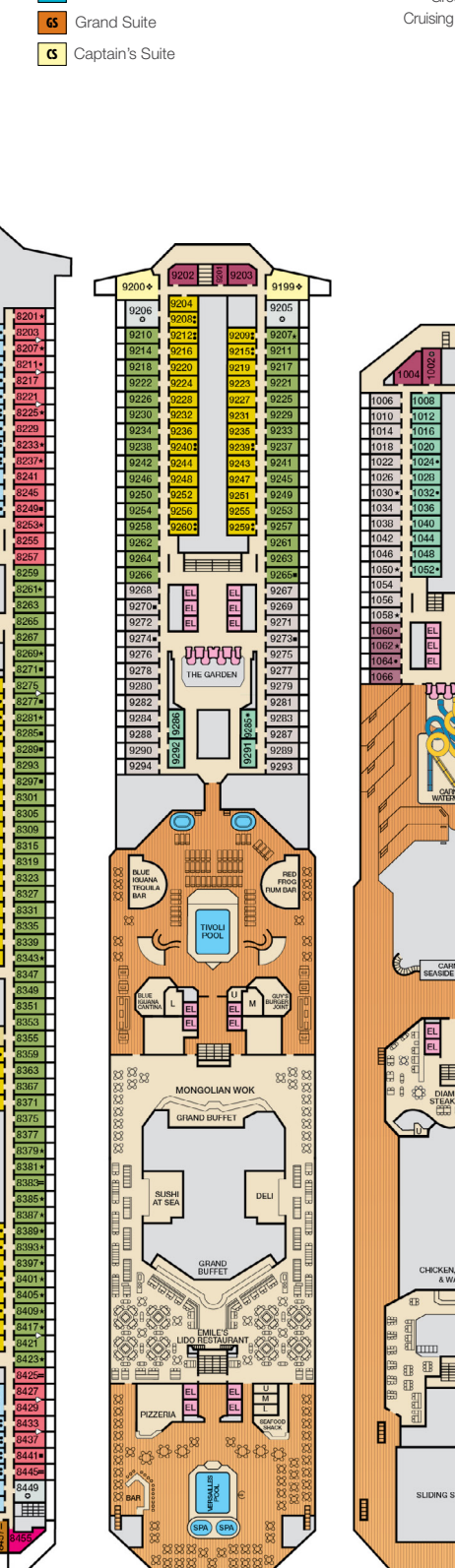

Promenade • Deck 5

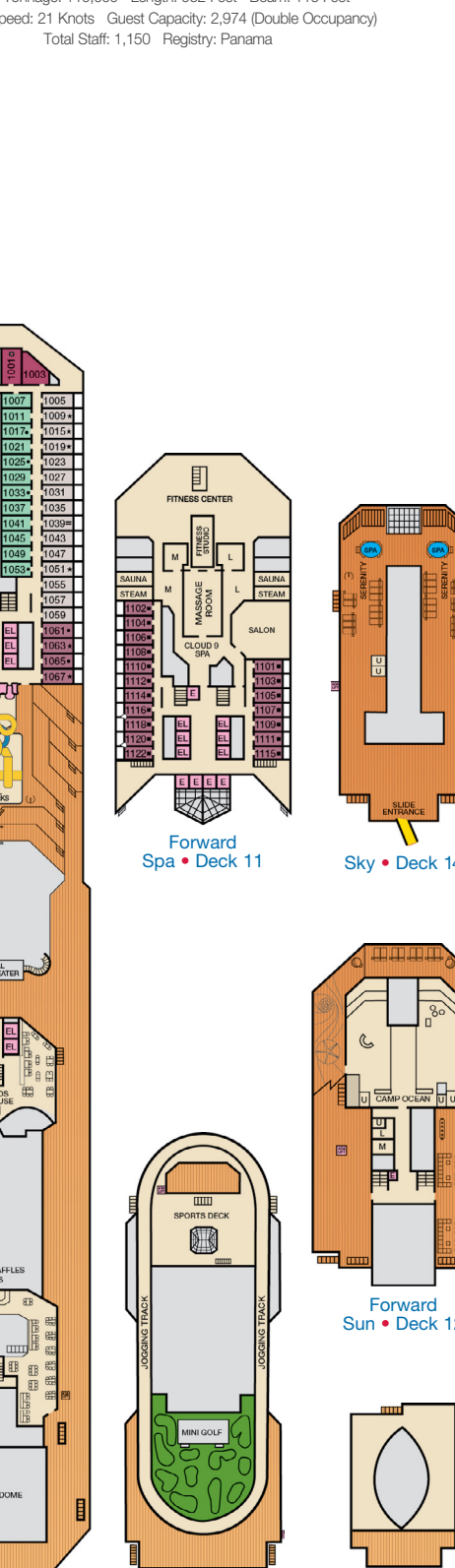

Upper • Deck 6



Empress • Deck 7

Verandah • Deck 8

Lido • Deck 9

Panorama • Deck 10

Aft Spa • Deck 11

Sky • Deck 14

Forward Spa • Deck 11

Forward Sun • Deck 12

ACCOMMODATIONS SYMBOL LEGEND

- ▲ Twin Bed and Single Sofa Bed
- ★ Twin Beds do not convert to a King Bed
- 2 Twin Beds (convert to King) and Single Sofa Bed
- ★ King Bed (does not convert to Twin beds) and Single Sofa Bed
- 2 Twin Beds (convert to King) and 1 Upper Pullman
- 2 Twin Beds (convert to King), Single Sofa Bed and 1 Upper Pullman
- † 2 Twin Beds (convert to King) and Double Sofa Bed

- ⊞ 2 Twin Beds (convert to King) and 2 Upper Pullmans
- ⊞ 2 Twin Beds (convert to King), Single Sofa Bed with Convertible Bunk
- ⊞ 2 Twin Beds (convert to King), Single Sofa Bed, 1 Upper Pullman and 1 Lower Pullman
- ◆ Stateroom with 2 Porthole Windows
- ◊ Connecting Staterooms (ideal for families and groups of friends)
- U Unisex Wheelchair Accessible Restroom

- 🚫 All accommodations are non-smoking.
- Accessible Routes including Ramps
- Restrooms, Elevators, Lifts and other Accessible Areas
- Fully Accessible Staterooms (FAC)
- Fully Accessible Staterooms - Single Side Approach (FAC-SSA)
- Ambulatory Accessible Staterooms (AAC)

DECK PLANS

Please contact Guest Access Services for specific ship accessibility features. You may also visit <http://www.carnival.com/about-carnival/special-needs>

Spa accommodations include private access, special amenities and priority reservations at the Cloud 9 Spa.

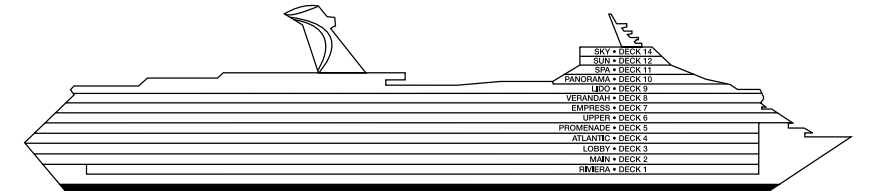

Gross Tonnage: 110,000 Length: 952 Feet Beam: 116 Feet Cruising Speed: 21 Knots
Guest Capacity: 2,974 (Double Occupancy) Total Staff: 1,150 Registry: Panama

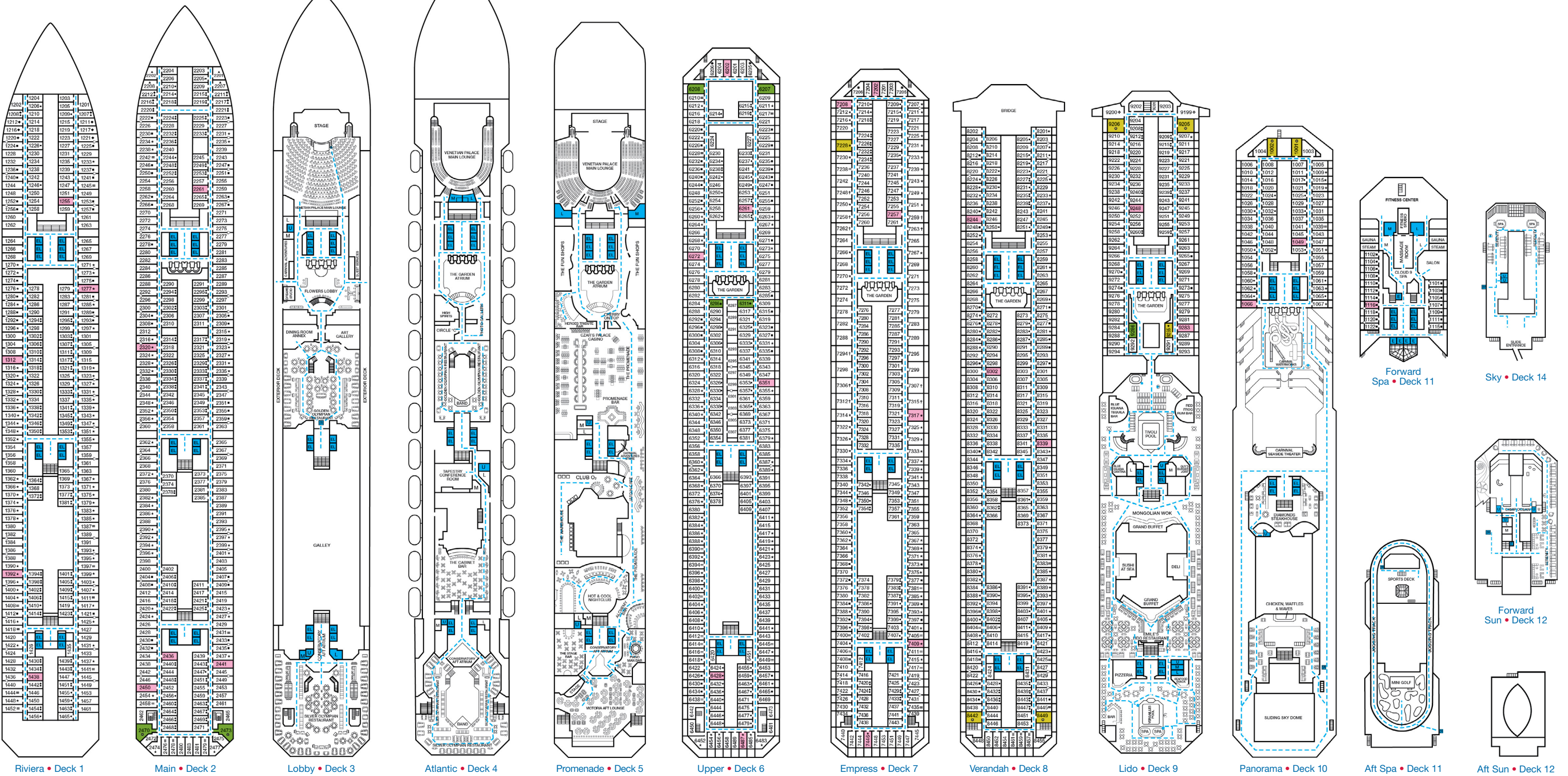

Riviera • Deck 1 Main • Deck 2 Lobby • Deck 3 Atlantic • Deck 4 Promenade • Deck 5 Upper • Deck 6 Empress • Deck 7 Verandah • Deck 8 Lido • Deck 9 Panorama • Deck 10 Aft Spa • Deck 11 Aft Sun • Deck 12